



Electrolux
PROFESSIONAL

**Modular Cooking Range Line
thermaline 80 - 500 mm Electric
Warming Cabinet with 1 door, GN
conform, 1 Side (H2) - H=550**

ITEM # _____

MODEL # _____

NAME # _____

SIS # _____

AIA # _____



588313 (MA4GDAEOAO)

Electric warming cabinet,
with 1 door, one-side
operated, GN - H2

Short Form Specification

Item No. _____

500 mm wide warming cabinet with 1 door, constructed according to DIN 18860_2 with 70 mm recessed plinth. Internal frame for heavy duty sturdiness in 2 mm and 3 mm in 1.4301 (AISI 304). 2 mm top in 1.4301 (AISI 304). Flat surface construction, easily cleanable. THERMODUL connection system enables seamless worktop when units are connected and avoids soil penetrating. Temperature in the cabinet can be set through thermostat, up to a maximum of 110 °C. Cabinet storage space accepts GN 1/1 containers.

IPX5 water resistant certification.

Configuration: One-side operated freestanding base, hygienic class H2.

Main Features

- All major components may be easily accessed from the front.
- THERMODUL connection system creates a seamless work top when units are connected to each other thus avoiding soil penetrating vital components and facilitating the removal of units in case of replacement or service.
- Unit constructed according to DIN 18860_2 with 70 mm recessed plinth.
- Temperature in the cupboard can be set through a thermostat to suit different requirements. The maximum temperature is 110° C.
- Unit can be installed below modular top appliances, designed to keep plates warm.

Construction

- IPX5 water resistance certification.
- 2 mm top in 1.4301 (AISI 304).
- Flat surface construction with minimal hidden areas to easily clean all surfaces
- Storage space in the base of the appliance accepts GN1/1 containers.
- Internal frame for heavy duty sturdiness in stainless steel.

Optional Accessories

- Stainless steel side panel, 800x800mm, freestanding PNC 912508 ☐
- Stainless steel front kicking strip, 500mm width PNC 912595 ☐
- Stainless steel side kicking strips left and right, freestanding, 800mm width PNC 912619 ☐
- Stainless steel side kicking strips left and right, wall mounted, 800mm width PNC 912622 ☐
- Stainless steel side kicking strips left and right, back-to-back, 1600mm width PNC 912625 ☐
- Stainless steel plinth, against wall, 500mm width PNC 912803 ☐
- Stainless steel plinth, freestanding, 500mm width PNC 912822 ☐
- Stainless steel panel, 800x800mm, against wall, left side PNC 913094 ☐
- Stainless steel panel, 800x800mm, flush-fitting, against wall, right side PNC 913098 ☐
- Back panel, 500x550mm, for bases and units, one-side operated PNC 913179 ☐
- Stainless steel side panel, left, h=800 PNC 913216 ☐
- Stainless steel side panel, right, h=800 PNC 913217 ☐

APPROVAL: _____



Experience the Excellence
www.electroluxprofessional.com
ELUX_EMAIL



Electrolux
PROFESSIONAL

**Modular Cooking Range Line
thermale 80 - 500 mm Electric Warming
Cabinet with 1 door, GN conform, 1 Side (H2) -
H=550**

- | | | |
|--|------------|--------------------------|
| • - NOT TRANSLATED - | PNC 913233 | <input type="checkbox"/> |
| • - NOT TRANSLATED - | PNC 913244 | <input type="checkbox"/> |
| • - NOT TRANSLATED - | PNC 913257 | <input type="checkbox"/> |
| • - NOT TRANSLATED - | PNC 913264 | <input type="checkbox"/> |
| • - NOT TRANSLATED - | PNC 913266 | <input type="checkbox"/> |
| • - NOT TRANSLATED - | PNC 913273 | <input type="checkbox"/> |
| • - NOT TRANSLATED - | PNC 913274 | <input type="checkbox"/> |
| • - NOT TRANSLATED - | PNC 913279 | <input type="checkbox"/> |
| • STAINLESS STEEL DIVIDING PANEL
800X800MM LEFT/RIGHT | PNC 913669 | <input type="checkbox"/> |
| • ELECTRIC MAINSWITCH 25A 4mm ²
NM FOR MODULAR H800 ELECTRIC
UNITS (FACTORY FITTED) | PNC 913676 | <input type="checkbox"/> |
| • - NOT TRANSLATED - | PNC 913685 | <input type="checkbox"/> |



**Modular Cooking Range Line
thermale 80 - 500 mm Electric Warming Cabinet with 1 door, GN
conform, 1 Side (H2) - H=550**
The company reserves the right to make modifications to the products
without prior notice. All information correct at time of printing.

2026.01.02

Front

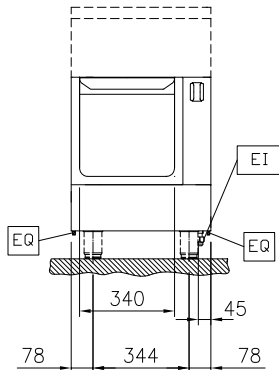

Side

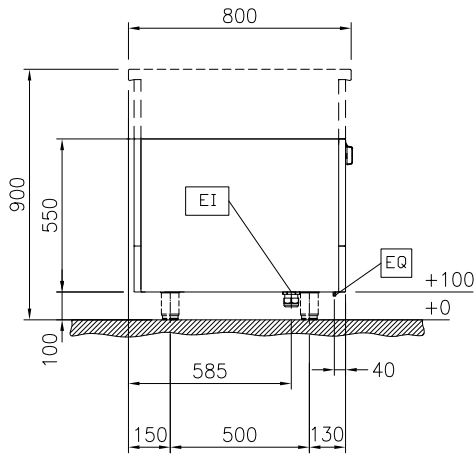

EI = Electrical inlet (power)

Top

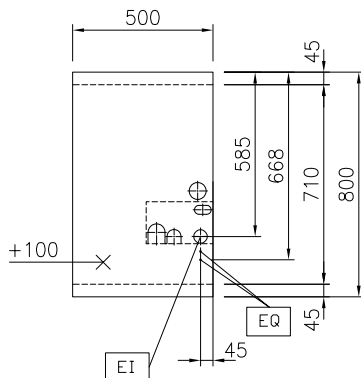

Key Information:

External dimensions, Width:	
588313 (MA4GDAEOAO)	500 mm
External dimensions, Depth:	800 mm
External dimensions, Height:	550 mm
Cupboard Cavity Dimensions (width):	340 mm
Cupboard Cavity Dimensions (height):	330 mm
Cupboard Cavity Dimensions (depth):	715 mm
Cabinet temperature range:	30-110 °C
Net weight:	23 kg

Sustainability

Current consumption:	2.5 Amps
----------------------	----------